

DERIVATORI CON CADUTA DI TENSIONE NOMINALE 60/150 mV

SHUNTS WITH RATED VOLTAGE DROP 60/150 mV

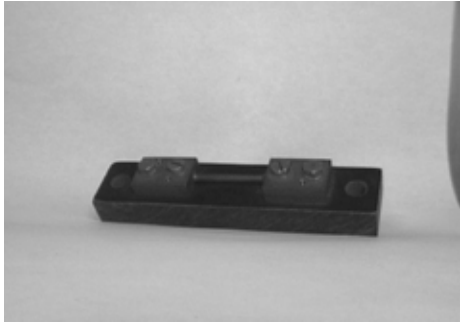

Caratteristiche generali

- Precisione classe 0,5 %
- Costruzione a norme DIN 43703 e raccomandazione IEC
- Tondini saldati con argento a 600 °C
- Completi di bulloneria per attacchi di corrente e presa di tensione
- Prese di tensione 2 viti M5 x 8 con 4 rondelle
- Cordoni doppi tarati (a richiesta): 1.5 m - 2.5 mm/q - 0.02 ohm

General features

- Accuracy class 0,5 %
- Manufactured according to DIN standard 43703 and IEC recommendations
- Soldering by silver to 600 °C
- Supplied with screw bolt for current and voltage connections
- Reconnections voltage: 2 screws M5 x 8 with 4 washers

60 mV

corrente nominale <i>rated current</i>	esec. fig. <i>exec. fig.</i>	dimensioni in mm. - <i>Dimension mm.</i>									attacchi di corrente - <i>current connections</i>		
		a1	a2	b1	b2	b3	c1	c2	e	h	numero	bulloni-screws bolts	dadi-nuts
1-1.5-2.5-4-6-10-15-25	1	-	28	20	-	-	8	-	78	-	2 x 1	M 5 X 12	-
40-60-100-150	1a	100	33	20	-	-	8	-	80	-	2 x 1	M 8 X 16	-
250	2	145	55	30	15	-	10	10	105	30	2 x 1	M 12 X 40	M 12
400-600	2	145	55	40	20	-	10	10	105	30	2 x 1	M 16 X 45	M 16
1000	2	165	65	60	30	-	10	10	115	30	2 x 1	M 20 X 50	M 20
1500	2	165	65	90	21	48	10	10	115	30	2 x 1	M 16 X 45	M 16
2500	2	165	65	120	30	60	10	10	115	30	2 x 2	M 20 X 50	M 20
4000	3	165	65	120	30	60	15	10	115	60	2 x 2	M 20 X 60	M 20
6000	3	175	70	154	25	52	25	15	125	130	2 x 3	M 20 X 75	M 20
10000	3	185	75	206	25	52	30	20	135	170	2 x 4	M 20 X 80	M 20
15000	3	185	75	310	25	52	30	20	135	170	2 x 6	M 20 X 80	M 20

corrente nominale <i>rated current</i>	autoconsumo W <i>selfconsumption W</i>	peso Kg <i>wght</i>	corrente nominale <i>rated current</i>	autoconsumo W <i>selfconsumption W</i>	peso Kg <i>wght</i>
1-1.5-2.5-4-6-10-15-25	0,06 - 1,5	0,20	40-50-60	2,4-3-3,6	0,15
80-100-120-150-200	4,8-6-7,2-9-12	0,15	250-300	15-18	0,50
400-500-600-800	24-30-36-48	0,80	1000-1200-1500	50-72-90	2,00
2000-2500-3000-4000	120-150-180-240	4,00	5000-6000-8000	300-360-480	10,0-17,5
10000	600	21,0	15000	900	27,0

150 mV

corrente nominale <i>rated current</i>	esec. fig. <i>exec. fig.</i>	dimensioni in mm. - <i>Dimension mm.</i>									attacchi di corrente - <i>current connections</i>		
		a1	a2	b1	b2	b3	c1	c2	e	h	numero	bulloni-screws bolts	dadi-nuts
1-1.5-2.5-4-6-10-15-25	1	-	28	20	-	-	8	-	78	-	2 x 1	M 5 X 12	-
40-60-100-150	1a	225	33	25	-	-	8	-	205	-	2 x 1	M 8 X 16	-
250	2	270	55	30	15	-	10	10	230	50	2 x 1	M 12 X 40	M 12
400-600	2	270	55	40	20	-	10	10	230	50	2 x 1	M 16 X 45	M 16
1000	2	290	65	70	35	-	10	10	240	60	2 x 1	M 20 X 50	M 20
1500	2	290	65	90	21	48	15	10	240	60	2 x 1	M 16 X 45	M 16
2500	2	290	65	120	30	60	15	10	240	60	2 x 2	M 20 X 50	M 20
4000	3	300	70	120	30	60	25	15	250	130	2 x 2	M 20 X 60	M 20
6000	3	300	70	154	25	52	25	15	250	130	2 x 3	M 20 X 75	M 20
10000	3	310	75	206	25	52	30	20	260	170	2 x 4	M 20 X 80	M 20
15000	3	310	75	310	25	52	30	20	260	170	2 x 6	M 20 X 80	M 20

corrente nominale <i>rated current</i>	autoconsumo W <i>selfconsumption W</i>	peso Kg <i>wght</i>	corrente nominale <i>rated current</i>	autoconsumo W <i>selfconsumption W</i>	peso Kg <i>wght</i>
1-1.5-2.5-4-6-10-15-25	0,15 - 3,75	0,20	40-50-60	6-7,5-9	0,15
80-100-120-150-200	12-15-18-22,5-30	0,15	250-300	37,5-45	0,50
400-500-600-800	60-75-90-120	0,85	1000-1200-1500	150-180-225	2,00
2000-2500-3000-4000	300-375-450-600	4,00	5000-6000-8000	750-900-1200	11,0-18,0
10000	1500	21,5	15000	2250	29,0

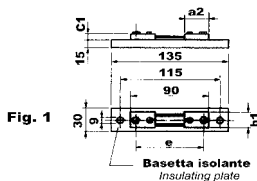

Fig. 1a

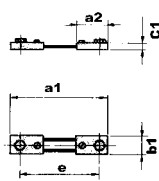

Fig. 2

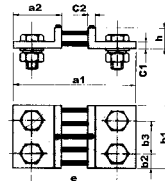

Fig. 3

